

# DIN7984

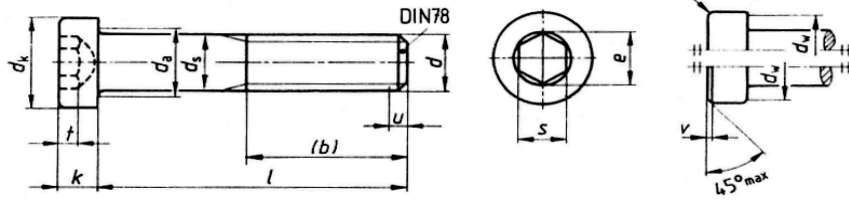

Lage cilinderschroef met binnenzeskant  
 Zylinderschraube mit Innensechskant und niedrigem Kopf  
 Hexagon socket head cap screws with low head

## Hetraco B.V.



Schroefdraad	M3	M4	M5	M6	M8	M10	M 12	M 14	M 16	M 18	M 20	M 22	M 24																																										
b	<table border="0"> <tr> <td><math>l \leq 1,25 \text{ mm}</math></td> <td>12</td><td>14</td><td>16</td><td>18</td><td>22</td><td>26</td><td>30</td><td>34</td><td>38</td><td>42</td><td>46</td><td>50</td><td>54</td> </tr> <tr> <td><math>1,25 \text{ mm} &gt; l \leq 200 \text{ mm}</math></td> <td>-</td><td>-</td><td>-</td><td>-</td><td>28</td><td>32</td><td>36</td><td>40</td><td>44</td><td>48</td><td>52</td><td>56</td><td>60</td> </tr> <tr> <td><math>l &gt; 200 \text{ mm}</math></td> <td>-</td><td>-</td><td>-</td><td>-</td><td>-</td><td>-</td><td>-</td><td>-</td><td>57</td><td>61</td><td>65</td><td>69</td><td>73</td> </tr> </table>													$l \leq 1,25 \text{ mm}$	12	14	16	18	22	26	30	34	38	42	46	50	54	$1,25 \text{ mm} > l \leq 200 \text{ mm}$	-	-	-	-	28	32	36	40	44	48	52	56	60	$l > 200 \text{ mm}$	-	-	-	-	-	-	-	-	57	61	65	69	73
$l \leq 1,25 \text{ mm}$	12	14	16	18	22	26	30	34	38	42	46	50	54																																										
$1,25 \text{ mm} > l \leq 200 \text{ mm}$	-	-	-	-	28	32	36	40	44	48	52	56	60																																										
$l > 200 \text{ mm}$	-	-	-	-	-	-	-	-	57	61	65	69	73																																										
dk	<table border="0"> <tr> <td>max.=maat</td> <td>5,5</td><td>7</td><td>8,5</td><td>10</td><td>13</td><td>16</td><td>18</td><td>21</td><td>24</td><td>27</td><td>30</td><td>33</td><td>36</td> </tr> <tr> <td>min.</td> <td>5,32</td><td>6,78</td><td>8,28</td><td>9,78</td><td>12,73</td><td>15,73</td><td>17,73</td><td>20,67</td><td>23,67</td><td>26,67</td><td>29,67</td><td>32,61</td><td>35,61</td> </tr> </table>													max.=maat	5,5	7	8,5	10	13	16	18	21	24	27	30	33	36	min.	5,32	6,78	8,28	9,78	12,73	15,73	17,73	20,67	23,67	26,67	29,67	32,61	35,61														
max.=maat	5,5	7	8,5	10	13	16	18	21	24	27	30	33	36																																										
min.	5,32	6,78	8,28	9,78	12,73	15,73	17,73	20,67	23,67	26,67	29,67	32,61	35,61																																										
da	<table border="0"> <tr> <td>max.</td> <td>3,6</td><td>4,7</td><td>5,7</td><td>6,8</td><td>9,2</td><td>11,2</td><td>13,7</td><td>15,7</td><td>17,7</td><td>20,2</td><td>22,4</td><td>24,4</td><td>26,4</td> </tr> </table>													max.	3,6	4,7	5,7	6,8	9,2	11,2	13,7	15,7	17,7	20,2	22,4	24,4	26,4																												
max.	3,6	4,7	5,7	6,8	9,2	11,2	13,7	15,7	17,7	20,2	22,4	24,4	26,4																																										
ds	<table border="0"> <tr> <td>max.=maat</td> <td>3</td><td>4</td><td>5</td><td>6</td><td>8</td><td>10</td><td>12</td><td>14</td><td>16</td><td>18</td><td>20</td><td>22</td><td>24</td> </tr> <tr> <td>min.</td> <td>2,86</td><td>3,82</td><td>4,82</td><td>5,82</td><td>7,78</td><td>9,78</td><td>11,73</td><td>13,73</td><td>15,73</td><td>17,73</td><td>19,67</td><td>21,67</td><td>23,67</td> </tr> </table>													max.=maat	3	4	5	6	8	10	12	14	16	18	20	22	24	min.	2,86	3,82	4,82	5,82	7,78	9,78	11,73	13,73	15,73	17,73	19,67	21,67	23,67														
max.=maat	3	4	5	6	8	10	12	14	16	18	20	22	24																																										
min.	2,86	3,82	4,82	5,82	7,78	9,78	11,73	13,73	15,73	17,73	19,67	21,67	23,67																																										
dw	<table border="0"> <tr> <td>min.</td> <td>4,84</td><td>6,2</td><td>7,7</td><td>9,2</td><td>12,03</td><td>15,03</td><td>17,03</td><td>19,83</td><td>22,83</td><td>25,83</td><td>28,83</td><td>31,61</td><td>34,61</td> </tr> </table>													min.	4,84	6,2	7,7	9,2	12,03	15,03	17,03	19,83	22,83	25,83	28,83	31,61	34,61																												
min.	4,84	6,2	7,7	9,2	12,03	15,03	17,03	19,83	22,83	25,83	28,83	31,61	34,61																																										
e	<table border="0"> <tr> <td></td> <td>2,3</td><td>2,87</td><td>3,44</td><td>4,58</td><td>5,72</td><td>8,01</td><td>9,15</td><td>11,43</td><td>13,72</td><td>13,72</td><td>16</td><td>16</td><td>19,44</td> </tr> </table>														2,3	2,87	3,44	4,58	5,72	8,01	9,15	11,43	13,72	13,72	16	16	19,44																												
	2,3	2,87	3,44	4,58	5,72	8,01	9,15	11,43	13,72	13,72	16	16	19,44																																										
k	<table border="0"> <tr> <td>max.=maat</td> <td>2</td><td>2,8</td><td>3,5</td><td>4</td><td>5</td><td>6</td><td>7</td><td>8</td><td>9</td><td>10</td><td>11</td><td>12</td><td>13</td> </tr> <tr> <td>min.</td> <td>1,86</td><td>2,66</td><td>3,32</td><td>3,82</td><td>4,82</td><td>5,82</td><td>6,78</td><td>7,78</td><td>8,78</td><td>9,78</td><td>10,73</td><td>11,73</td><td>12,73</td> </tr> </table>													max.=maat	2	2,8	3,5	4	5	6	7	8	9	10	11	12	13	min.	1,86	2,66	3,32	3,82	4,82	5,82	6,78	7,78	8,78	9,78	10,73	11,73	12,73														
max.=maat	2	2,8	3,5	4	5	6	7	8	9	10	11	12	13																																										
min.	1,86	2,66	3,32	3,82	4,82	5,82	6,78	7,78	8,78	9,78	10,73	11,73	12,73																																										
s	<table border="0"> <tr> <td>maat</td> <td>2</td><td>2,5</td><td>3</td><td>4</td><td>5</td><td>7</td><td>8</td><td>10</td><td>12</td><td>12</td><td>14</td><td>14</td><td>17</td> </tr> <tr> <td>min</td> <td>2,02</td><td>2,52</td><td>3,02</td><td>4,02</td><td>5,02</td><td>7,025</td><td>8,025</td><td>10,025</td><td>12,032</td><td>12,032</td><td>14,032</td><td>14,032</td><td>17,05</td> </tr> <tr> <td>max</td> <td>2,10</td><td>2,60</td><td>3,10</td><td>4,12</td><td>5,14</td><td>7,175</td><td>8,175</td><td>10,175</td><td>12,212</td><td>12,212</td><td>14,212</td><td>14,212</td><td>17,23</td> </tr> </table>													maat	2	2,5	3	4	5	7	8	10	12	12	14	14	17	min	2,02	2,52	3,02	4,02	5,02	7,025	8,025	10,025	12,032	12,032	14,032	14,032	17,05	max	2,10	2,60	3,10	4,12	5,14	7,175	8,175	10,175	12,212	12,212	14,212	14,212	17,23
maat	2	2,5	3	4	5	7	8	10	12	12	14	14	17																																										
min	2,02	2,52	3,02	4,02	5,02	7,025	8,025	10,025	12,032	12,032	14,032	14,032	17,05																																										
max	2,10	2,60	3,10	4,12	5,14	7,175	8,175	10,175	12,212	12,212	14,212	14,212	17,23																																										
t	<table border="0"> <tr> <td>maat</td> <td>1,5</td><td>2,3</td><td>2,7</td><td>3</td><td>3,8</td><td>4,5</td><td>5</td><td>5,3</td><td>5,5</td><td>6,5</td><td>7,5</td><td>8</td><td>8</td> </tr> <tr> <td>min.</td> <td>1,38</td><td>2,18</td><td>2,58</td><td>2,88</td><td>3,65</td><td>4,35</td><td>4,85</td><td>5,15</td><td>5,35</td><td>6,32</td><td>7,32</td><td>7,82</td><td>7,82</td> </tr> <tr> <td>max.</td> <td>1,62</td><td>2,42</td><td>2,82</td><td>3,12</td><td>3,95</td><td>4,65</td><td>5,15</td><td>5,45</td><td>5,65</td><td>6,68</td><td>7,68</td><td>8,18</td><td>8,18</td> </tr> </table>													maat	1,5	2,3	2,7	3	3,8	4,5	5	5,3	5,5	6,5	7,5	8	8	min.	1,38	2,18	2,58	2,88	3,65	4,35	4,85	5,15	5,35	6,32	7,32	7,82	7,82	max.	1,62	2,42	2,82	3,12	3,95	4,65	5,15	5,45	5,65	6,68	7,68	8,18	8,18
maat	1,5	2,3	2,7	3	3,8	4,5	5	5,3	5,5	6,5	7,5	8	8																																										
min.	1,38	2,18	2,58	2,88	3,65	4,35	4,85	5,15	5,35	6,32	7,32	7,82	7,82																																										
max.	1,62	2,42	2,82	3,12	3,95	4,65	5,15	5,45	5,65	6,68	7,68	8,18	8,18																																										
v	<table border="0"> <tr> <td>max.</td> <td>0,3</td><td>0,4</td><td>0,5</td><td>0,6</td><td>0,8</td><td>1</td><td>1,2</td><td>1,4</td><td>1,6</td><td>1,8</td><td>2</td><td>2,2</td><td>2,4</td> </tr> </table>													max.	0,3	0,4	0,5	0,6	0,8	1	1,2	1,4	1,6	1,8	2	2,2	2,4																												
max.	0,3	0,4	0,5	0,6	0,8	1	1,2	1,4	1,6	1,8	2	2,2	2,4																																										

maat	l	
	min.	max.
5	4,76	5,24
6	5,76	6,24
8	7,71	9,29
10	9,71	10,29
12	11,65	12,35
14	13,65	14,35
16	15,65	16,35
18	17,65	18,35
20	19,58	20,42
25	24,58	25,42
30	29,58	30,42
35	34,5	35,5
40	39,5	40,5
45	44,5	45,5
50	49,5	50,5
55	54,4	55,6
60	59,4	60,6
70	69,4	70,6
80	79,4	80,6
90	89,3	90,7
100	99,3	100,7

Aan de inhoud kunnen geen rechten worden ontleend. / No rights can be derived from the information provided in this publication.